

**Robinsons**  
VICTORIAN ALUMINIUM GREENHOUSES  
75 Years of Aluminium Greenhouses



[www.robsonsgreenhouses.co.uk](http://www.robsonsgreenhouses.co.uk)



Made in the United Kingdom

## Introduction to Robinsons

For over 75 years, amateur and professional growers alike have recognised Robinsons as being at the very forefront of the greenhouse world. Renowned for their strength, precision engineering and practical features, Robinsons greenhouses are still the benchmark against which other greenhouses are measured. If you want the best in your garden, then keep reading!

### History

Started in 1947, the company has moved around over the years including spells at Winchester, Southampton and Southam. Now based in Staffordshire, a nice central location for nationwide distribution.



### Still made in Britain today

All Robinsons greenhouses are made in our factory in Staffordshire. The aluminium raw material is also extruded in the UK.



Radley model shown in Old Cottage Green

## The Robinsons Victorian

This Robinsons Victorian range offers you a choice of greenhouses with a distinctive Victorian style.

The addition of cast aluminium spandrels at both eaves and ridge strengthens the greenhouse considerably and the extra height created by the more traditional 45 degree pitch to the roof gives more air in the greenhouse as well as more room for specimen plants. The 45 degree roof pitch is also said to be better for light transmission.

### Features of the Victorian ranges

- Extra wide guttering with Victorian styling.
- Cast aluminium spandrels increase strength and improve the Victorian look.
- Hinged door with wide access, lock and low threshold.
- Choice of glass to ground or low wall models.
- 45 degree pitch of roof gives extra height, better atmosphere and more light transmission as well as Victorian feel.
- Louvre side vents included as standard.
- Extra strong box section ridge bar for rigidity.
- Increased number of automatic roof vents.



# Contemporary Colours

## Stunning range of colours

### Contemporary Colours (aluminium colour capping)

These five Robinsons colours are finished with an Aluminium capping system that is less prone to fading in the sun than PVC capping - particularly on darker shades.



**Old Cottage Green** - Blend in with your garden with this pleasant green, like the windows from an old English cottage.



**Pastel Sage** - A pale stone colour with a greenish hint.



**Ivory** - This ivory colour is popular on Victorian models, the off-white shade adds a subtle antique effect.



**Anthracite** - Popular in the window industry, anthracite is a sophisticated and modern shade of dark grey.

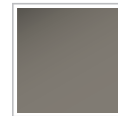

**Light Bronze** - A metallic stone colour.

FREE colour sample plates - ask your agent for a sample.

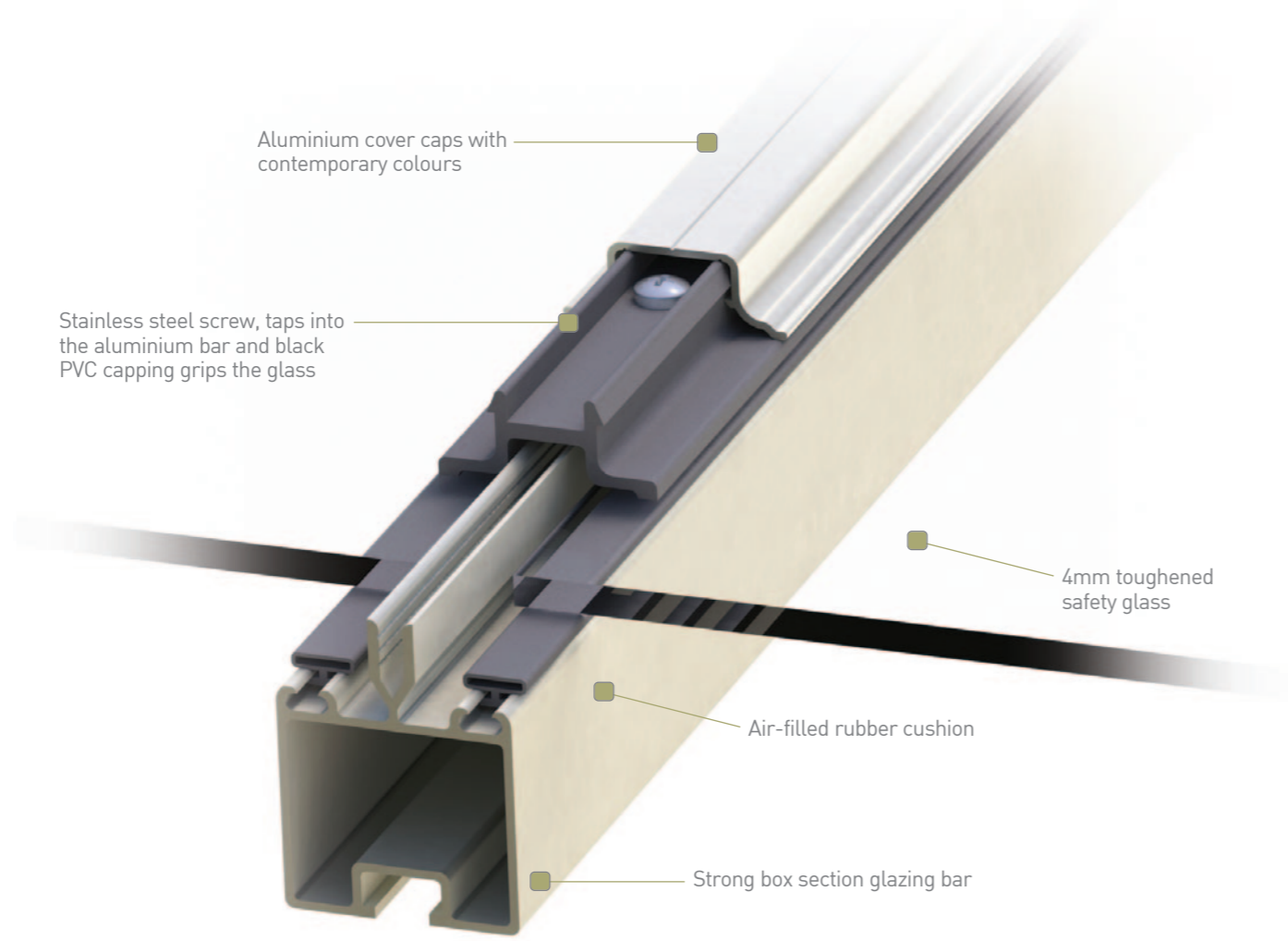

Aluminium cover caps with contemporary colours

Stainless steel screw, taps into the aluminium bar and black PVC capping grips the glass

4mm toughened safety glass

Air-filled rubber cushion

Strong box section glazing bar



Old Cottage Green



Pastel Sage



Ivory



Anthracite



Light Bronze

# Robinsons Here's why it's worth investing in a Robinsons Victorian

Optional Victorian ridge cresting is made from cast aluminium in matching colour and adds a decorative touch to your greenhouse. Some gardeners tell us that it also deters pigeons from perching on the greenhouse roof.



These Victorian models come with generous ventilation including an increased number of Bayliss XL automatic openers. These ingenious devices simply expand in the rising heat and open the roof vent, releasing the warm air when needed.

The extra height created by the more traditional 45 degree pitch to the roof gives more air in the greenhouse as well as more room for specimen plants. The 45 degree roof pitch is also said to be better for light transmission.



The addition of cast aluminium spandrels to both ridge and eaves strengthens the greenhouse considerably as well as improving the Victorian style.

Optional integral 3 slat shelf is very strong, adjustable to different heights and fills the whole length of the greenhouse.



Extra wide integral aluminium guttering with Victorian styling and PVC downpipes.

Optional integral staging is extremely strong, and because it bolts to the side of the greenhouse, you can set it to the perfect working height, plus with no vertical legs in the way, you can make the most of your ground space.



Attention to detail means that the Robinsons greenhouse is far better 'finished off' than many greenhouses.

Embossed lower panel aluminium hinged door with lockable handle. Wide 32" opening with low level threshold for easy access.



These high quality louvres draw cooler air in to replace the warm air that is released by your automatic roof vents.

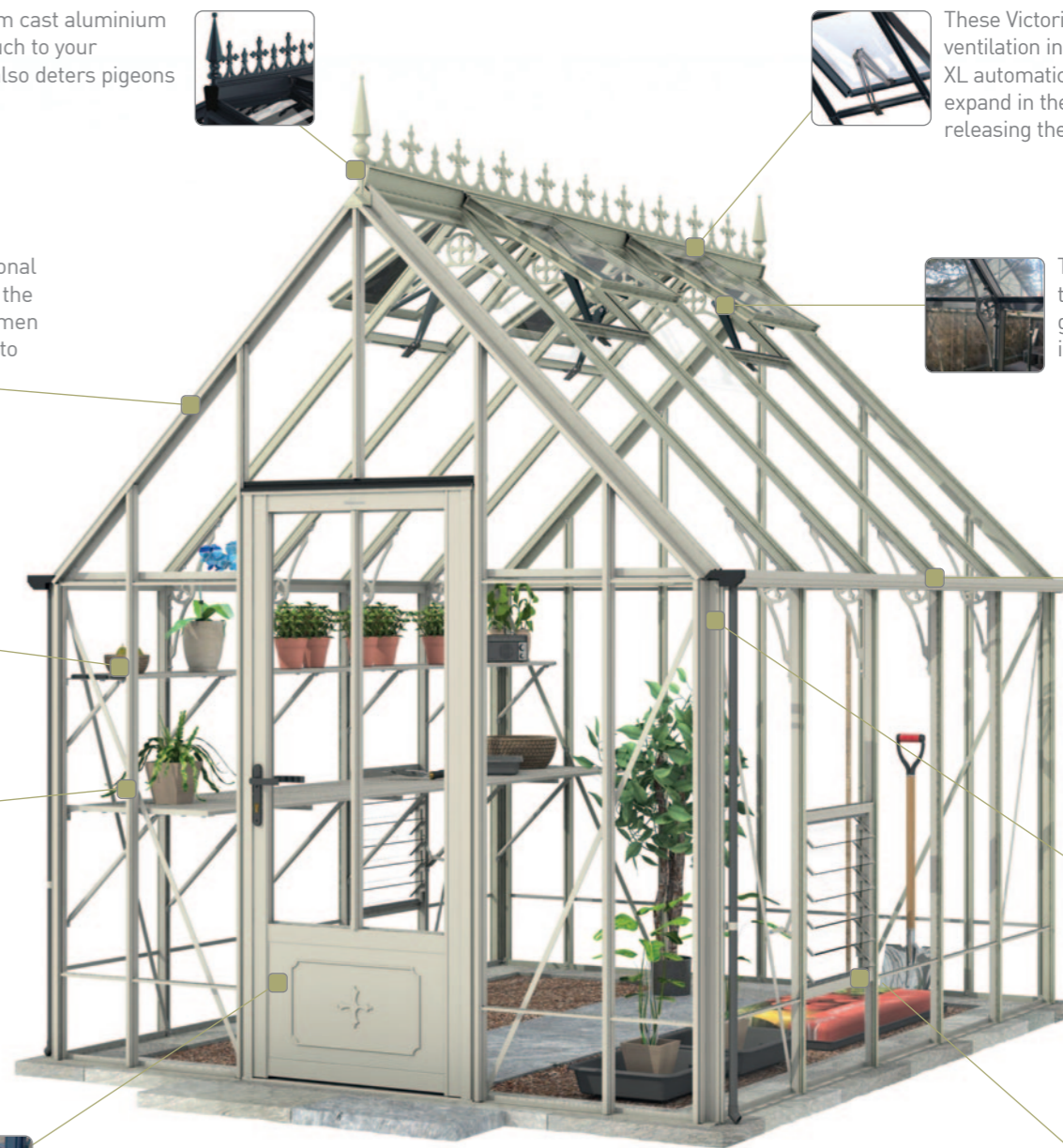

## Special adaptations

There are a number of relatively easy modifications that can be made to a Robinsons Victorian greenhouse which will help you if you are needing a slightly more bespoke greenhouse:

### R-Type modification

This is where we remove the rear gable end of your greenhouse so that it can join onto an existing wall or building.

This allows you to create a completely different type of lean-to greenhouse.

When ordering an R-Type, the price of the greenhouse itself can be reduced by deducting £50 per foot of width.

The Ratcliffe model shown in the photo is an 8ft wide greenhouse meaning the price would be reduced by £400 for this modification.



8x16 Rushmoor in Pastel Sage with an R-Type modification

### Z-Type modification

With this modification you are able to specify the height of the wall you want the full height greenhouse to sit on i.e. 5'6" eaves height - plus your wall. This gives you the opportunity to fit the greenhouse over an existing doorway for instance.

The brick wall must be built to an official special base plan provided by us.

The most common heights customers choose are 150mm, 300mm, 450mm and 600mm as a course of bricks is usually 75mm. We then modify the door end of the greenhouse so that the door drops down to ground level and adjust the glass above the door.

The cost of the Z-Type modification is £300 per doorway.



A Rushby in Old Cottage Green raised on a Z-Type 750mm wall to fit over an existing doorway on a building

## V-Type modification

This modification is becoming increasingly popular as it allows for one side of your Victorian greenhouse to be removed and a valley gutter assembly is attached so that it can join onto an existing wall.

Victorian style brackets are also supplied to support the valley gutter inside the greenhouse.

Some minor onsite fabrications are required and information is provided on how to do this. Please ensure that the wall is straight and strong enough to support part of the greenhouse.

A special dimensions drawing will be provided by us for this type of modification.



Valley gutter assembly interior with supporting Victorian style brackets

## Fitting service

These modifications can easily be made in the factory, but there are no special instructions written, so its usually best to engage an experienced Robinsons greenhouse fitter to do these jobs. Please discuss this with your local expert.



9x16 Radley in Pastel Sage with a V-Type modification to attach it to the garden wall



6x8 Repton in Pastel Sage with optional staging both sides and crested



6x8 Rugby in Anthracite

# Robinsons ALUMINIUM GREENHOUSES

## Repton & Rugby

6x8 Rugby model in Ivory



### Robinsons Repton 6'6" Wide (1972mm)

- ✓ High eaves ✓ Toughened glass ✓ Bar capping ✓ Guttering & Downpipes
- ✓ Auto-vents ✓ Ground level door threshold

#### Specification

- High eaves (5'6") for more space
- Extremely strong 'Box Section' glazing bars
- Toughened safety glass & screw in bar capping as standard
- Locking hinged door with low level threshold
- Integral gutter with downpipes
- Automatic roof vents, and louvre side vents (man)
- 10 year framework Guarantee



Nominal base length	6'7"	8'8"	10'8"	12'8"	14'8"	16'9"	Extension 8'1"
Actual base length (B)	2012mm	2632mm	3252mm	3872mm	4492mm	5112mm	2480mm
No of roof vents	Two	Two	Four	Four	Four	Four	Two
Large pane toughened safety glass	✓	✓	✓	✓	✓	✓	✓
No of louvre side vents	Two	Two	Two	Two	Two	Four	Two
<b>Greenhouse Price</b>	<b>£4499</b>	<b>£4999</b>	<b>£5499</b>	<b>£5999</b>	<b>£6499</b>	<b>£6999</b>	<b>£2000</b>
3 slat (11") Shelf one side	£180	£240	£300	£360	£420	£480	£240
5 slat (18") Staging one side	£360	£480	£600	£720	£840	£960	£480
Victorian Cresting including Finials (Cast aluminium)	£390	£470	£550	£630	£710	£790	£320

Note all prices shown are the net discounted prices incl VAT at 20%.

#### Dimensions

A = 1972mm (6'6")  
 B = See table  
 C = 1692mm (5'6")  
 D = 2736mm (9')  
 E = 818mm (32")  
 F = 1979mm (6'6")

Auto-louvre £45

- #### Options
- Extra roof vents including auto opener **£149**
  - Louvre side vents **£199**
  - Hanging basket brackets (10) **£29**



Optional finials only (pair) **£150**



Strong Frame with box section glazing bars



Low level door threshold

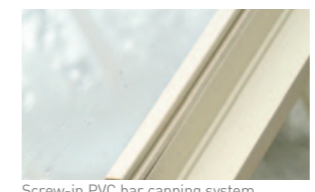

Screw-in PVC bar capping system



Old Cottage Green Pastel Sage Ivory

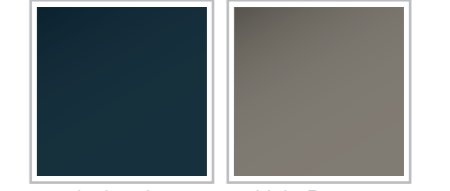

Anthracite Light Bronze

### Rugby Low Wall 6'6" Wide (1972mm)

The low wall version of the Repton is called the Rugby. You would need to build a 525mm height low wall (to the official plan) for this greenhouse to sit on. The price and measurements are the same as the Repton glass to ground model.





# Raynham & Ranby

7x12 Raynham in Old Cottage Green with optional crestring



## Robinsons Raynham 7'6" Wide (2302mm)

- ✓ High Eaves ✓ Toughened glass ✓ Bar capping ✓ Guttering & Downpipes
- ✓ Auto-vents ✓ Ground level door threshold

### Specification

- High eaves (5'6") for more space
- Extremely strong 'Box Section' glazing bars
- Toughened safety glass & screw in bar capping as standard
- Locking hinged door with low level threshold
- 10 year framework Guarantee
- Traditional porch design
- Automatic roof vents, and louvre side vents (man)
- 10 year framework Guarantee



Nominal base length	8'8"	12'8"	16'9"	20'10"	24'10"	Extension 8'1"
Actual base length (A)	2632mm	3872mm	5112mm	6352mm	7592mm	2480mm
No of roof vents (of which; one in porch)	Two	Four	Five	Six	Six	Two
Large pane toughened safety glass	✓	✓	✓	✓	✓	✓
'No of louvre side vents	Two	Two	Four	Four	Four	Two
Greenhouse Price	£7999	£8999	£9999	£10999	£11999	£2000
3 slat (11") Shelf along back	£240	£360	£480	£600	£720	£240
7 slat (25") Staging along back	£560	£840	£1120	£1400	£1680	£560
Victorian Cresting including Finials (Cast aluminium)	£705	£865	£1025	£1185	£1345	£320

Note all prices shown are the net discounted prices incl VAT at 20%.

### Dimensions

- A = See table
- B = 2302mm (7'6")
- C = 1692mm (5'6")
- D = 2763mm (9')
- E = 818mm (2'8")
- F = 1979mm (6'5")
- G = 1972mm (6'5")
- H = 1972mm (6'5")
- J = 2,763mm (9')

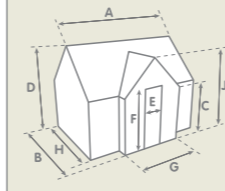

### Options

- Extra roof vents including auto opener **£149**
- Louvre side vents **£199**
- Hanging basket brackets (10) **£29**
- Extra door **£799**

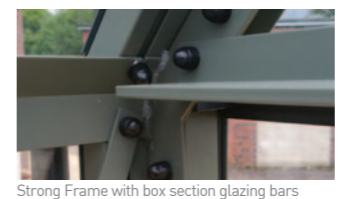

Old Cottage Green Pastel Sage Ivory



Anthracite Light Bronze

## Ranby Low Wall 7'6" Wide (2302mm)

The low wall version of the Raynham is called the Ranby. You would need to build a 525mm height low wall (to the official plan) for this greenhouse to sit on. The price and sizes are the same as the Raynham glass to ground model.





# Ratcliffe & Rushmoor

8x6 Ratcliffe shown in Ivory finish with optional staging, shelf and cresting



8x12 Ratcliffe shown in Anthracite with optional staging, shelf and cresting



8x10 Rushmoor in Pastel Sage with optional staging and shelf



## Robynsons Ratcliffe 8'7" Wide (2602mm)

- ✓ High Eaves ✓ Toughened glass ✓ Bar capping ✓ Guttering & Downpipes
- ✓ Auto-vents ✓ Ground level door threshold

### Specification

- High eaves (5'6") for more space
- Extremely strong 'Box Section' glazing bars
- Toughened safety glass & screw in bar capping as standard
- Locking hinged door with low level threshold
- Integral gutter with downpipes
- Automatic roof vents, and louvre side vents (man)
- 10 year framework Guarantee

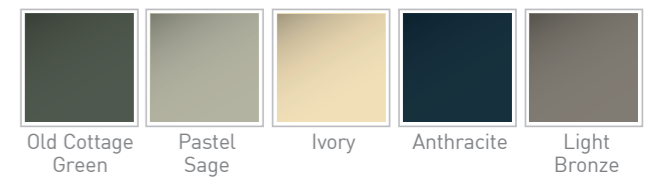

Nominal base length Actual base length (B)	6'7" 2012mm	8'7" 2632mm	10'8" 3252mm	12'8" 3872mm	14'8" 4492mm	16'9" 5112mm	18'9" 5732mm	20'10" 6352mm	22'10" 6984mm	24'10" 7592mm	Extension 8'1" 2480 mm
No of roof vents	Two	Two	Four	Four	Four	Four	Six	Six	Six	Six	Two
Large pane toughened safety glass	✓	✓	✓	✓	✓	✓	✓	✓	✓	✓	✓
'No of louvre side vents	Two	Two	Two	Two	Four	Four	Four	Four	Six	Six	Two
<b>Greenhouse Price</b>	<b>£6499</b>	<b>£7249</b>	<b>£7999</b>	<b>£8749</b>	<b>£9499</b>	<b>£10249</b>	<b>£10999</b>	<b>£11749</b>	<b>£12499</b>	<b>£13249</b>	<b>£3000</b>
3 slat (11") Shelf one side	£180	£240	£300	£360	£420	£480	£540	£600	£660	£720	£240
7 slat (25") Staging one side	£420	£560	£700	£840	£980	£1120	£1260	£1400	£1540	£1680	£560
Victorian Cresting including Finials (Cast aluminium)	£390	£470	£550	£630	£710	£790	£870	£950	£1030	£1110	£320

Note all prices shown are the net discounted prices incl VAT at 20%.

### Dimensions

A = 2606mm (8'7")  
 B = See table  
 C = 1692mm (5'6")  
 D = 3078mm (10'1")  
 E = 818mm (32")  
 F = 1979mm (6'6")

Auto-louvre £45

- ### Options
- Extra roof vents including auto opener **£149**
  - Louvre side vents **£199**
  - Hanging basket brackets (10) **£29**
  - Internal partition with door **£1999**



Optional finials only (pair) **£150**

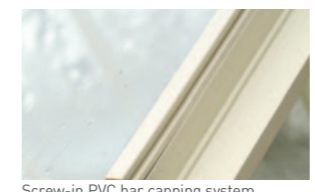

## Rushmoor Low Wall 8'7" Wide (2602mm)

The low wall version of the Ratcliffe is called the Rushmoor. You would need to build a 525mm height low wall (to the official plan) for this greenhouse to sit on. The price and measurements are the same as the Ratcliffe glass to ground model.





# Radley & Rushby

9x12 Rushby shown in Light Bronze with optional crestring, staging and shelf



9x12 Radley shown in Old Cottage Green with optional crestring



## Robinsons Radley 9'7" Wide (2935mm)

- ✓ High Eaves ✓ Toughened glass ✓ Bar capping ✓ Guttering & Downpipes
- ✓ Auto-vents ✓ Ground level door threshold

### Specification

- High eaves (5'6") for more space
- Extremely strong 'Box Section' glazing bars
- Toughened safety glass & screw in bar capping as standard
- Locking hinged door with low level threshold
- 10 year framework Guarantee
- Traditional porch design
- Automatic roof vents, and louvre side vents (man)
- 10 year framework Guarantee



Nominal base length	8'8"	12'8"	16'9"	20'10"	24'10"	Extension 8'1"
Actual base length (A)	2632mm	3872mm	5112mm	6352mm	7592mm	2480mm
No of roof vents (of which; one in porch)	Two	Five	Five	Seven	Eight	Two
Large pane toughened safety glass	✓	✓	✓	✓	✓	✓
'No of louvre side vents	Two	Two	Four	Four	Six	Two
<b>Greenhouse Price</b>	<b>£9999</b>	<b>£11499</b>	<b>£12999</b>	<b>£14499</b>	<b>£15999</b>	<b>£3000</b>
3 slat (11") Shelf along back	£240	£360	£480	£600	£720	£240
7 slat (25") Staging along back	£560	£840	£1120	£1400	£1680	£560
Victorian Cresting including Finials (Cast aluminium)	£780	£940	£1100	£1260	£1420	£320

Note all prices shown are the net discounted prices incl VAT at 20%.

### Dimensions

A = See table  
 B = 2935mm (9'7")  
 C = 1692mm (5'6")  
 D = 3078mm (10'1")  
 E = 818mm (32")  
 F = 1979mm (6'6")  
 G = 1972mm (6'6")  
 H = 2606mm (8'7")  
 J = 2736mm (9')

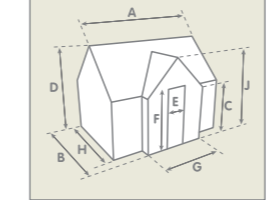

- ### Options
- Extra roof vents including auto opener **£149**
  - Louvre side vents **£199**
  - Hanging basket brackets (10) **£29**
  - Internal partition with door **£1999**
  - Extra door **£799**

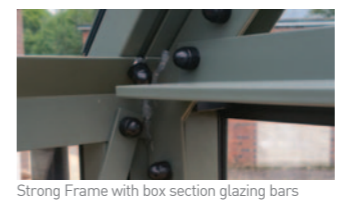

Old Cottage Green Pastel Sage Ivory

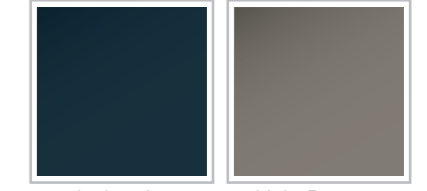

Anthracite Light Bronze

## Rushby Low Wall 9'7" Wide (2935mm)

The low wall version of the Radley is called the Rushby. You would need to build a 525mm height low wall (to the official plan) for this greenhouse to sit on. The price and sizes are the same as the Radley glass to ground model.







# Robynson Roydon

9x20 Roydon in Old Cottage Green showing crested, staging and shelf



## Robynson Roydon 9'7" Wide (2929mm)

- ✓ High Eaves ✓ Toughened glass ✓ Bar capping ✓ Guttering & Downpipes
- ✓ Auto-vents ✓ Ground level door threshold

### Specification

- High eaves (5'6") for more space
- Extremely strong 'Box Section' glazing bars
- Toughened safety glass & screw in bar capping as standard
- Locking hinged door with low level threshold
- Integral gutter with downpipes
- Automatic roof vents, and louvre side vents (man)
- 10 year framework Guarantee



Nominal base length Actual base length (B)	6'7" 2012mm	8'7" 2632mm	10'8" 3252mm	12'8" 3872mm	14'8" 4492mm	16'9" 5112mm	18'9" 5732mm	20'10" 6352mm	22'10" 6984mm	24'10" 7592mm	Extension 8'1" 2480 mm
No of roof vents	Two	Two	Three	Four	Four	Four	Five	Six	Six	Six	Two
Large pane toughened safety glass	✓	✓	✓	✓	✓	✓	✓	✓	✓	✓	✓
'No of louvre side vents	One	One	Two	Two	Two	Two	Three	Three	Three	Three	Two
<b>Greenhouse Price</b>	<b>£7499</b>	<b>£8499</b>	<b>£9499</b>	<b>£10499</b>	<b>£11499</b>	<b>£12499</b>	<b>£13499</b>	<b>£14499</b>	<b>£15499</b>	<b>£16499</b>	<b>£4000</b>
3 slat (11") Shelf one side	£180	£240	£300	£360	£420	£480	£540	£600	£660	£720	£240
7 slat (25") Staging one side	£420	£560	£700	£840	£980	£1120	£1260	£1400	£1540	£1680	£560
10 slat (35") Staging one side	£615	£820	£1025	£1230	£1435	£1640	£1845	£2050	£2255	£2460	£820
Victorian Cresting including Finials (Cast aluminium)	£390	£470	£550	£630	£710	£790	£870	£950	£1030	£1110	£320

Note all prices shown are the net discounted prices incl VAT at 20%.

### Dimensions

- A = 2929mm (9'7")
- B = See table
- C = 1692mm (5'6")
- D = 3545mm (11'7")
- E = 818mm (32")
- F = 1979mm (6'6")

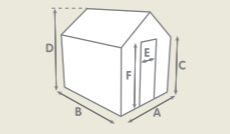

### Options

- Extra roof vents including auto opener **£149**
- Louvre side vents **£199**
- Hanging basket brackets (10) **£29**
- Extra door **£799**





# Reigate & Roedean

11x20 Reigate shown in Ivory with optional cresting, staging and shelf



11'x12' Roedean in Ivory with optional cresting, staging and shelf



## Robinsons Reigate 11'7" Wide (3536mm)

- ✓ High eaves ✓ Toughened glass ✓ Bar capping ✓ Guttering & Downpipes
- ✓ Auto-vents ✓ Ground level door threshold

### Specification

- High eaves (5'6") for more space
- Extremely strong 'Box Section' glazing bars
- Toughened safety glass & screw in bar capping as standard
- Locking hinged door with low level threshold
- Integral gutter with downpipes
- Automatic roof vents, and louvre side vents (man)
- 10 year framework Guarantee

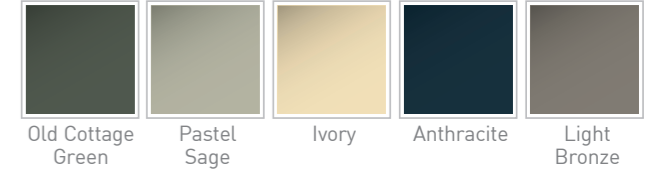

Nominal base length Actual base length (B)	6'7" 2012mm	8'7" 2632mm	10'8" 3252mm	12'8" 3872mm	14'8" 4492mm	16'9" 5112mm	18'9" 5732mm	20'10" 6352mm	22'10" 6984mm	24'10" 7592mm	Extension 8'1" 2480 mm
No of roof vents	Two	Two	Four	Four	Four	Four	Six	Six	Six	Six	Two
Large pane toughened safety glass	✓	✓	✓	✓	✓	✓	✓	✓	✓	✓	✓
'No of louvre side vents	Two	Two	Two	Two	Four	Four	Four	Four	Six	Six	Two
<b>Greenhouse Price</b>	<b>£7499</b>	<b>£8499</b>	<b>£9499</b>	<b>£10499</b>	<b>£11499</b>	<b>£12499</b>	<b>£13499</b>	<b>£14499</b>	<b>£15499</b>	<b>£16499</b>	<b>£4000</b>
3 slat (11") Shelf one side	£180	£240	£300	£360	£420	£480	£540	£600	£660	£720	£240
7 slat (25") Staging one side	£420	£560	£700	£840	£980	£1120	£1260	£1400	£1540	£1680	£560
10 slat (35") Staging one side	£615	£820	£1025	£1230	£1435	£1640	£1845	£2050	£2255	£2460	£820
Victorian Cresting including Finials (Cast aluminium)	£390	£470	£550	£630	£710	£790	£870	£950	£1030	£1110	£320

Note all prices shown are the net discounted prices incl VAT at 20%.

### Dimensions

- A = 3536mm (11'7")
- B = See table
- C = 1692mm (5'6")
- D = 3545mm (11'7")
- E = 818mm (32")
- F = 1979mm (6'6")

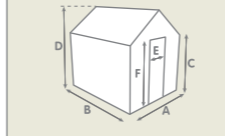

Auto-louvre £45

### Options

- Extra roof vents including auto opener **£149**
- Louvre side vents **£199**
- Hanging basket brackets (10) **£29**
- Internal partition with door **£2199**



Strong Frame with box section glazing bars



Low level door threshold



Screw-in PVC bar capping system



Optional finials pair **£150**

## Roedean Low Wall 11'7" Wide (3536mm)

The low wall version of the Reigate is called the Roedean. You would need to build a 525mm height low wall (to the official plan) for this greenhouse to sit on. The price and measurements are the same as the Reigate glass to ground model.





# Rolleston

12x16 Rolleston shown in Anthracite with optional crestring

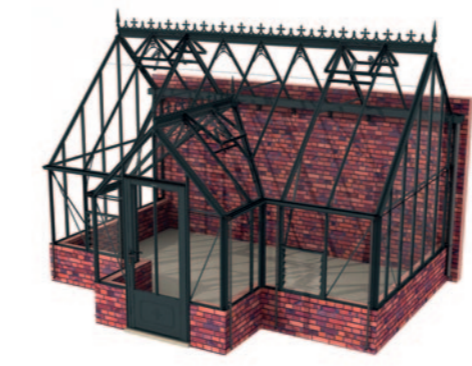
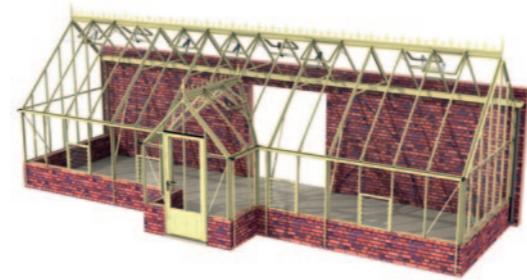
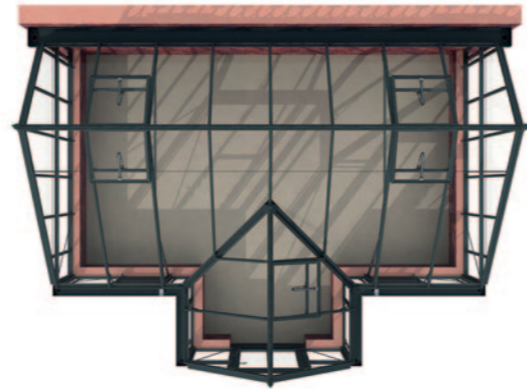
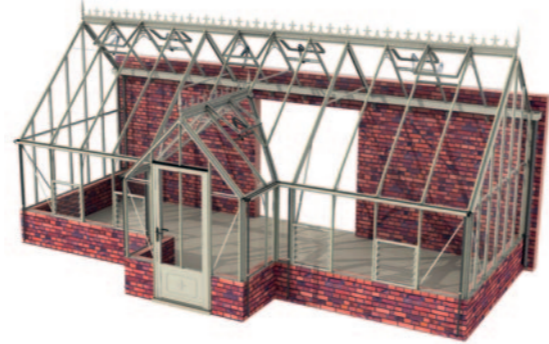

## Robinsons Rolleston 12'8" Wide (3862mm)

- ✓ High Eaves ✓ Toughened glass ✓ Bar capping ✓ Guttering & Downpipes
- ✓ Auto-vents ✓ Ground level door threshold

### Specification

- High eaves (5'6") for more space
- Extremely strong 'Box Section' glazing bars
- Toughened safety glass & screw in bar capping as standard
- Locking hinged door with low level threshold
- Traditional porch design
- Integral gutter with downpipes
- Automatic roof vents, and louvre side vents (man)
- 10 year framework Guarantee



Nominal base length Actual base length (B)	8'7" 2632mm	16'9" 5110mm	24'10" 7592mm	33' 10072mm	Extension 8'1" 2480mm
No of roof vents	Three	Five	Seven	Nine	Two
Large pane toughened safety glass	✓	✓	✓	✓	✓
*No of louvre side vents	Two	Two	Four	Four	Two
<b>Greenhouse Price</b>	<b>£11999</b>	<b>£15999</b>	<b>£19999</b>	<b>£23999</b>	<b>£4000</b>
3 slat (11") Shelf one side	£240	£480	£720	£960	£240
7 slat (25") Staging one side	£560	£1120	£1680	£2240	£560
10 slat (35") Staging along back	£820	£1640	£,460	£3485	£820
Victorian Cresting including Finials (Cast aluminium)	£860	£1180	£1500	£1820	£320

Note all prices shown are the net discounted prices incl VAT at 20%.

### Dimensions

- A = See table
- B = 3862mm (12'8")
- C = 1723mm (5'7")
- D = 3557mm (11'8")
- E = 818mm (2'8")
- F = 1988mm (6'6")
- G = 1968mm (6'5")
- H = 2929mm (9'7")
- J = 2736mm (8'11")

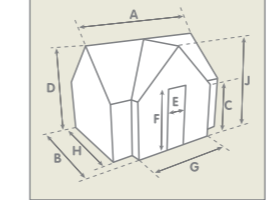

### Options

- Extra roof vents including auto opener **£149**
- Louvre side vents **£199**
- Hanging basket brackets (10) **£29**
- Extra door **£799**



Old Cottage Green Pastel Sage Ivory

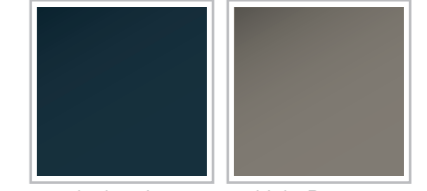

Anthracite Light Bronze

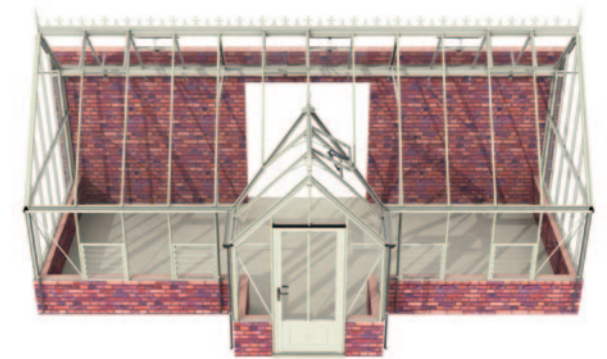
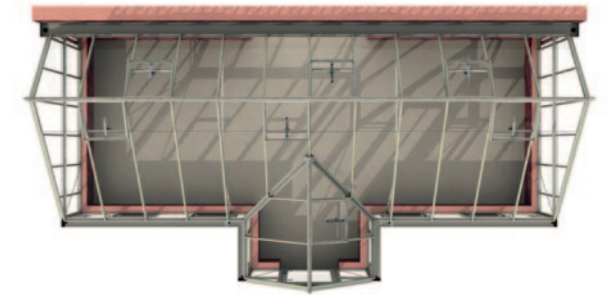



**Robyns**  
ALUMINIUM GREENHOUSES  
**Rochester**

13x12 Rochester shown in Pastel Sage with optional cresting



**Robyns Rochester**  
13'7" Wide (4162mm)

- ✓ High Eaves ✓ Toughened glass ✓ Bar capping ✓ Guttering & Downpipes
- ✓ Auto-vents ✓ Ground level door threshold

**Specification**

- High eaves (5'6") for more space
- Extremely strong 'Box Section' glazing bars
- Toughened safety glass & screw in bar capping as standard
- Locking hinged door with low level threshold
- Traditional porch design
- Integral gutter with downpipes
- Automatic roof vents, and louvre side vents (man)
- 10 year framework Guarantee



Nominal base length Actual base length (B)	12'8" 3872mm	20'10" 6352mm	28'11" 8832mm	37'1" 11312mm	Extension 8'1" 2480mm
No of roof vents	Five	Seven	Nine	Eleven	Two
Large pane toughened safety glass	✓	✓	✓	✓	✓
'No of louvre side vents	Two	Two	Four	Four	Two
<b>Greenhouse Price</b>	<b>£13999</b>	<b>£17999</b>	<b>£21999</b>	<b>£25999</b>	<b>£4000</b>
3 slat (11") Shelf one side	£360	£600	£840	£1,080	£240
7 slat (25") Staging one side	£840	£1400	£1960	£2520	£560
10 slat (35") Staging along back	£1230	£2050	£2870	£3690	£820
Victorian Cresting including Finials (Cast aluminium)	£1100	£1420	£1740	£2060	£320

Note all prices shown are the net discounted prices incl VAT at 20%.

**Dimensions**

- A = See table
- B = 4162mm (13ft7")
- C = 1723mm (5'7")
- D = 3557mm (11'8")
- E = 818mm (2'8")
- F = 1988mm (6'6")
- G = 2606mm (8ft6")
- H = 2929mm (9'7")
- J = 3078mm (10ft1")

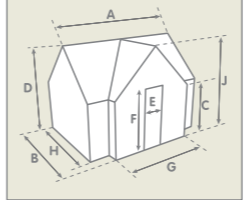

**Options**

- Extra roof vents including auto opener **£149**
- Louvre side vents **£199**
- Hanging basket brackets (10) **£29**
- Extra door **£799**

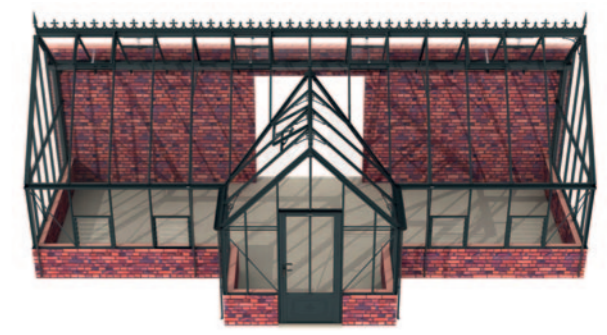
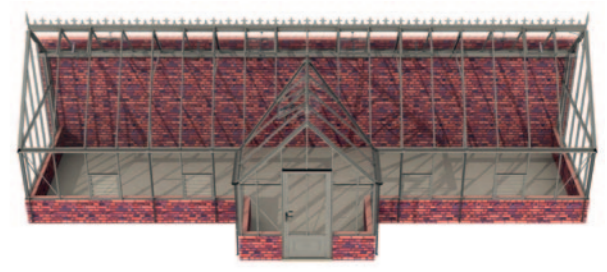
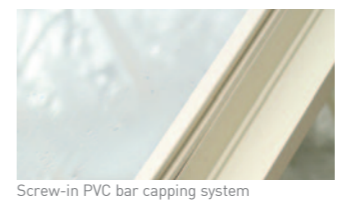

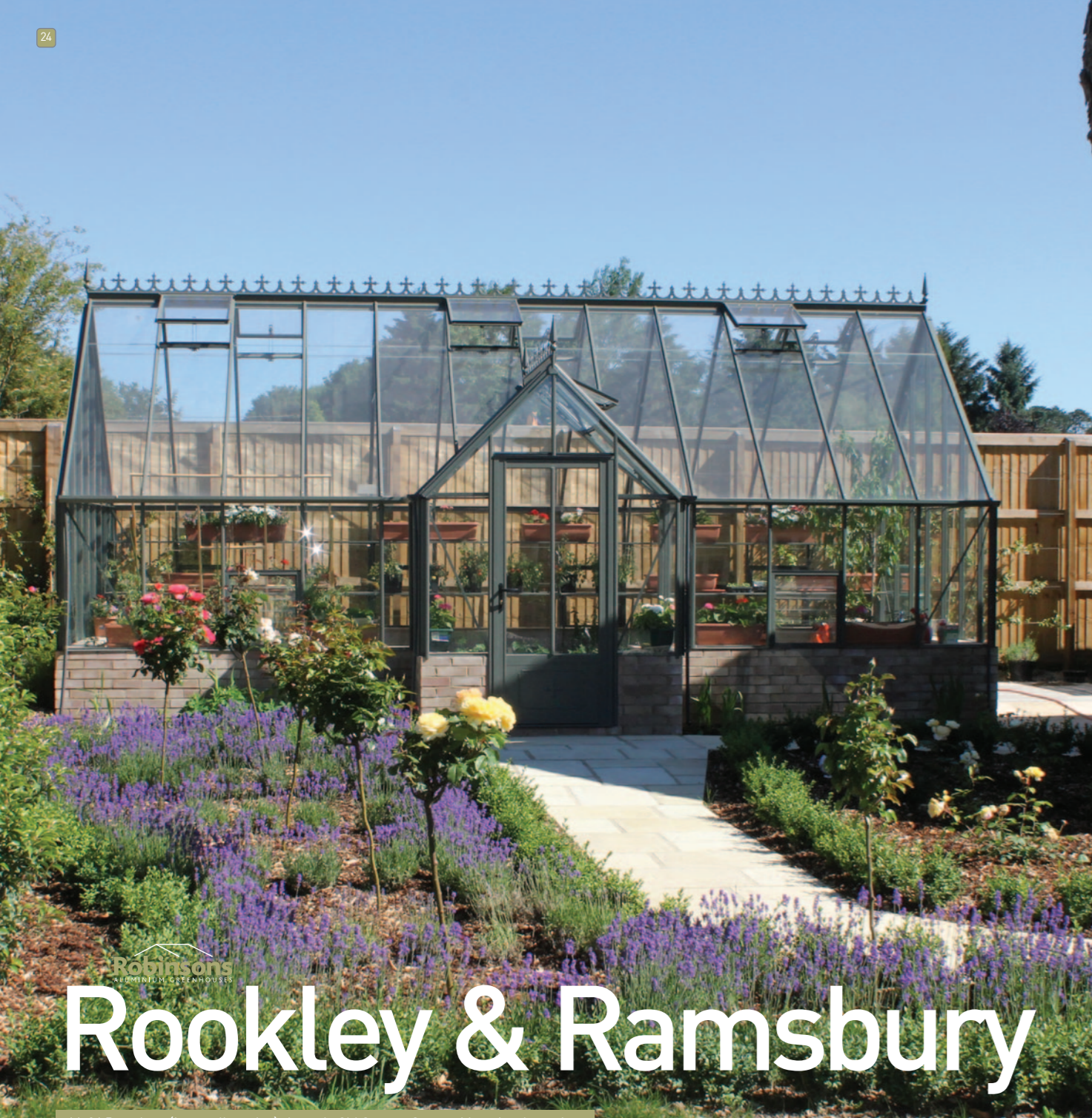

# Rookley & Ramsbury

14x24 Ramsbury (Low wall version) shown in Old Cottage Green with optional cresting



14x16 Ramsbury in Ivory with optional cresting



## Robinsons Rookley 14'8" Wide (4459mm)

- ✓ High Eaves ✓ Toughened glass ✓ Bar capping ✓ Guttering & Downpipes
- ✓ Auto-vents ✓ Ground level door threshold

### Specification

- High eaves (5'6") for more space
- Extremely strong 'Box Section' glazing bars
- Toughened safety glass & screw in bar capping as standard
- Locking hinged door with low level threshold
- Traditional porch design
- Integral gutter with downpipes
- Automatic roof vents, and louvre side vents (man)
- 10 year framework Guarantee



Nominal base length Actual base length (B)	8'7" 2632mm	16'9" 5110mm	24'10" 7592mm	33' 10072mm	Extension 8'1" 2480mm
No of roof vents	Three	Five	Seven	Nine	Two
Large pane toughened safety glass	✓	✓	✓	✓	✓
*No of louvre side vents	Two	Four	Six	Eight	Two
<b>Greenhouse Price</b>	<b>£11999</b>	<b>£15999</b>	<b>£19999</b>	<b>£23999</b>	<b>£4000</b>
3 slat (11") Shelf one side	£240	£480	£720	£960	£240
7 slat (25") Staging one side	£560	£1120	£1680	£2240	£560
10 slat (35") Staging along back	£820	£1640	£2460	£3485	£820
Victorian Cresting including Finials (Cast aluminium)	£860	£1180	£1500	£1820	£320

Note all prices shown are the net discounted prices incl VAT at 20%.

### Dimensions

- A = See table
- B = 4459mm (14'8")
- C = 1692mm (5'6")
- D = 3558mm (11'8")
- E = 818mm (32")
- F = 1979mm (6'6")
- G = 1968mm (6'5")
- H = 3536mm (11'7")
- J = 2736mm (9'0")

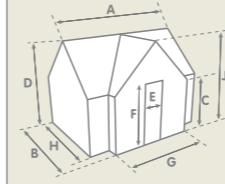

### Options

- Extra roof vents including auto opener **£149**
- Louvre side vents **£199**
- Hanging basket brackets (10) **£29**
- Internal partition with door **£2199**
- Extra door **£799**

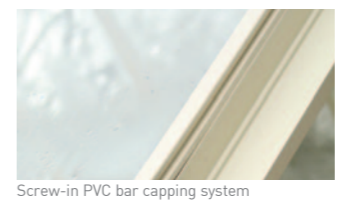

Old Cottage Green Pastel Sage Ivory

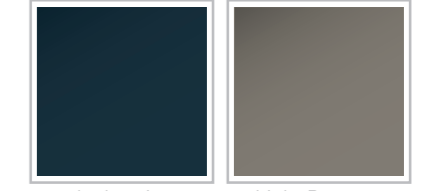

Anthracite Light Bronze

## Ramsbury Low Wall 14'8" Wide (4459mm)

The low wall version of the Rookley is called the Ramsbury. You would need to build a 525mm height low wall (to the official plan) for this greenhouse to sit on. The price and sizes are the same as the Rookley glass to ground model.





# Reicliffe & Roemoor

15x36 Roemoor shown in Ivory with V Type adaptation and an extra door



## Robinsons Reicliffe 15'9" Wide (4791mm)

- ✓ High Eaves ✓ Toughened glass ✓ Bar capping ✓ Guttering & Downpipes
- ✓ Auto-vents ✓ Ground level door threshold

### Specification

- High eaves (5'6") for more space
- Extremely strong 'Box Section' glazing bars
- Toughened safety glass & screw in bar capping as standard
- Locking hinged door with low level threshold
- Traditional porch design
- Integral gutter with downpipes
- Automatic roof vents, and louvre side vents (man)
- 10 year framework Guarantee



Nominal base length	12'8"	20'10"	28'11"	37'1"	Extension 8'1"
Actual base length (B)	2632mm	5110mm	7592mm	11312 mm	2480mm
No of roof vents	Five	Seven	Nine	Eleven	Two
Large pane toughened safety glass	✓	✓	✓	✓	✓
*No of louvre side vents	Two	Four	Six	Eight	Two
<b>Greenhouse Price</b>	<b>£13999</b>	<b>£17999</b>	<b>£21999</b>	<b>£25999</b>	<b>£4000</b>
3 slat (11") Shelf one side	£360	£600	£840	£1080	£240
7 slat (25") Staging one side	£840	£1400	£1960	£2520	£560
10 slat (35") Staging along back	£1230	£2050	£2870	£3690	£820
Victorian Cresting including Finials (Cast aluminium)	£1100	£1420	£1740	£2060	£320

Note all prices shown are the net discounted prices incl VAT at 20%.

### Dimensions

- A = See table
- B = 4791mm (15'9")
- C = 1692mm (5'6")
- D = 3545mm (11'7")
- E = 818mm (32")
- F = 1979mm (6'6")
- G = 2602mm (8'7")
- H = 3536mm (11'7")
- J = 3078mm (10'1")

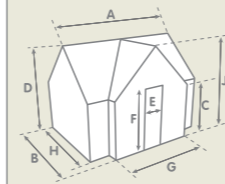

### Options

- Extra roof vents including auto opener **£149**
- Louvre side vents **£199**
- Hanging basket brackets (10) **£29**
- Internal partition with door **£2199**
- Extra door **£799**

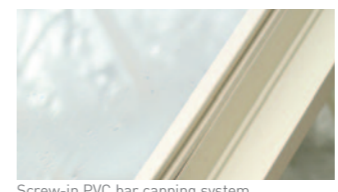

Old Cottage Green Pastel Sage Ivory

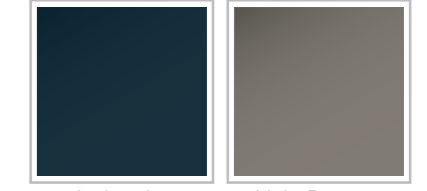

Anthracite Light Bronze

## Roemoor Low Wall 15'9" Wide (4791mm)

The low wall version of the Reicliffe is called the Roemoor. You would need to build a 525mm height low wall (to the official plan) for this greenhouse to sit on. The price and sizes are the same as the Reicliffe glass to ground model.



### What sort of base should I prepare?

There are lots of choices for your base, the main principles being that the base should be firm, level and square.

The most popular option is level paving slabs as these are easy to lay, and water can drain away between the slabs. Remember that water must be able to get away, so sealed solid bases such as painted or tiled concrete can result in lying water unless drainage is built in.

Water will also be free to move in or out of the greenhouse in between the cill and the slabs - if you are growing in strict humidity controlled conditions, then you may wish to keep this to a minimum and in this instance, we recommend that you build a one brick high plinth for the greenhouse to sit on.

Your base will affect the long term strength and stability



of your greenhouse, so it is worth investing at this stage. It is vital that your greenhouse is anchored down to the base. With most models we supply L-shaped brackets and screws & rawl plugs for this purpose.

Bases such as Tarmac or block paving are not ideal as anchorage can be difficult. Note that gravel is not best friends with greenhouses either - if you really want gravel nearby choose a large size stone so that it doesn't interfere with the door. Your local distributor may be able to help you with your base.

Please note that no greenhouse is an exact size in feet - they are always bigger than the nominal size - so what is called an 8x10 greenhouse would actually be nearer to 8'6" x 10'8".

Please only prepare a base when you are in possession of the official base sizes which are only given in mm, we send these out with your order confirmation.

For Low wall models we will supply a detailed plan of the wall measurements.

### Can you assemble the greenhouse for me?

All Robinsons greenhouses are sold on a 'self-assembly' basis, and will be delivered in kit form,

however we do recommend that you engage an experienced greenhouse fitter to assemble the greenhouse for you. Your local Agent will be able to arrange this for you.

### Delivery Times

Your greenhouse will be hand made to order and delivery times vary throughout the year.

### Delivery Costs

Mainland UK Free delivery, except postcodes AB, DD, IV, KW, PH and TR +£100. For off-shore, we can crate the glass and pack for onward shipment for £250. Any shortages can only be sent to mainland address.

### Guarantee

Your Robinsons greenhouse comes with a free 10 year frame guarantee. This covers the frame and powder coating against faulty manufacture. Moving parts are guaranteed for 12 months.

Exclusions include: glazing, wind damage, Labour, and accidental damage.

### Where can I order my greenhouse

From your local Agent - to find your nearest, please enter your postcode into the website:

[www.robinsonsgreenhouses.co.uk](http://www.robinsonsgreenhouses.co.uk)

**10**  
YEAR  
FRAME  
GUARANTEE

Please note that no greenhouse is 100% waterproof, and we do not recommend that non-greenhouse items such as soft furnishings are used in a greenhouse. E&O E.

Your local agent:

**Robinsons**  
ALUMINIUM GREENHOUSES

